



SUGIMOTO

H y d r a u l i c

杉本油压

产品选型 X PRODUCT SELECTION

板翅片式冷却器



材料: 铝合金
Material: aluminum alloy

最高工作压力: 2.5MPa
Maximum working pressure: < 2.5MPa

最高使用温度: <130° C
Maximum service temperature: < 130 °C

适用流体: 不与铝合金产生化学反应流体工质
Applicable fluid: working fluid without chemical reaction with aluminum alloy

板 - 翅片式冷却器特点:

结构紧密, 体积小, 重量轻, 换热面更大, 换热效率更好。密封流体通道内有内翅片, 流体通道外焊接波浪形外翅片, 导热更迅速。每单位的换热面积, 板翅片式冷却器相较于套接铜管式或其他材质或结构, 有更佳的换热效能, 至少达到10-20倍。

Compact structure, small volume, light weight, larger heat exchange surface and better heat exchange efficiency. There are inner fins in the sealed fluid channel, and wavy outer fins are welded outside the fluid channel to conduct heat more rapidly. Per unit of heat exchange area, plate fin cooler has better heat exchange efficiency than socket copper tube or other materials or structures, at least 10-20 times

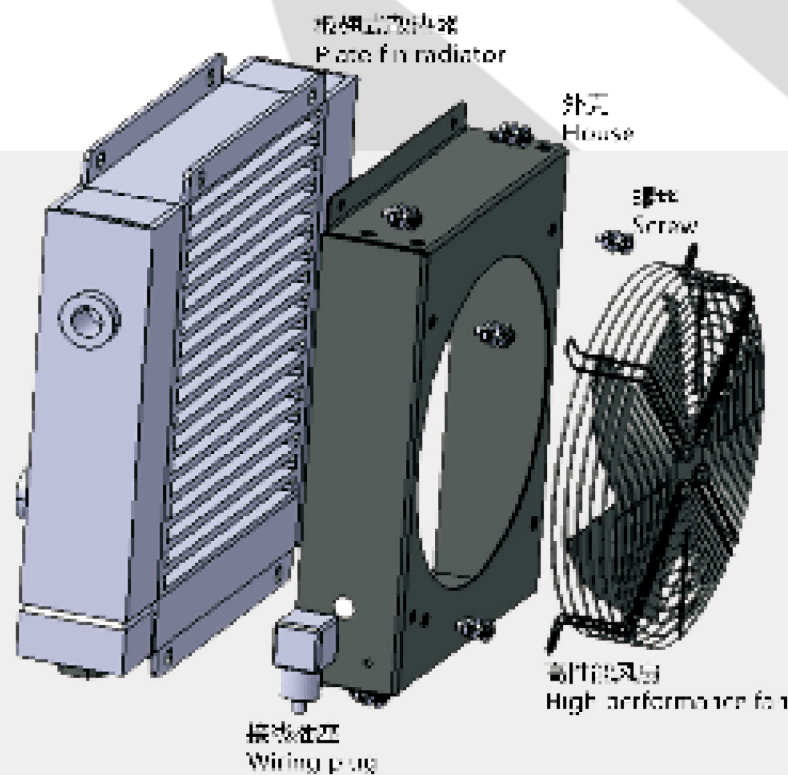
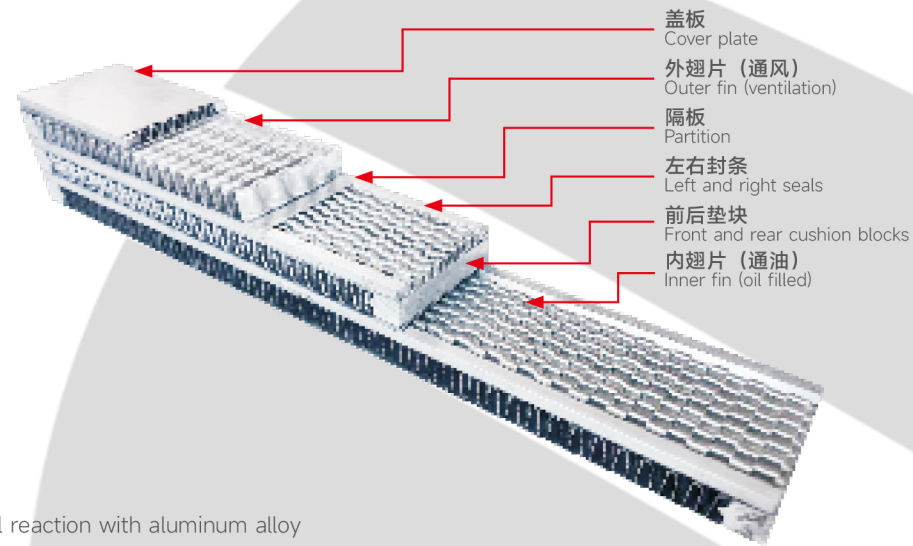

关于产品 X ABOUT PRODUCT

产品目录



AJ0510T-CA	P9
AJ1025T-CA	P10
AJ0607T-CA	P11
AJ0608T	P12
AJ0608TL	P13
AJ1012T	P14
AF0510T-CA	P15
AF1025T-CA	P16
AL608T-CA	P17
AL404T-CA	P18
AH0607T-CA	P19
AH0608T-CA	P20
AH0608TL-CA	P21
AH1012T	P22
AH1012T1	P23
AH1012TB	P24
AH1417T-CA	P25
AH1417TB	P26
AH1470TB	P27
AH1470T-CA	P28
AH1490T-CA	P29
AH1490TB	P30
AH1680T-CA	P31
AH2431T-CA	P32
AH3818T-CA	P33
AJ5435T-36	P34
HPW-5A/10A	P35
HPW-15A/25A	P36
汽车变速箱油冷	P37
汽车发动机油冷	P38
RS1500-KS 矿山机械 / 油缸	P39
矿机、服务器等非标准定制	P40

AJ 系列 X AJ SERIES

AJ0607T-CA



风冷却器 AIR COOLER

产品配置 PRODUCT CONFIGURATION			
形式 Form	AJ0607T-CA	冷却能力 Cooling capacity	1.05KW
流量 Flow	40L/min	重量 Weight	2.5KG
工作压力 Working pressure	≤ 2MPa	包装尺寸 Package size	28.5*14*22cm
风扇功率 Fan power	34W	风扇电压 Fan voltage	AC110V/AC220V-240V/AC380V/DC12V/DC24V/50HZ
外翅片散热面积 Fan power	0.8 m ²	注：特殊电压特殊尺寸可按要求定制 Special voltage size can be customized	



AJ 系列 X AJ SERIES

AJ0608T



风冷却器 AIR COOLER

产品配置 PRODUCT CONFIGURATION			
形式 Form	AJ0608T	冷却能力 Cooling capacity	1.8KW
流量 Flow	60L/min	重量 Weight	4KG
工作压力 Working pressure	≤ 2MPa	包装尺寸 Package size	35.5*14*21.5cm
风扇功率 Fan power	34W	风扇电压 Fan voltage	AC110V/AC220V-240V/AC380V/DC12V/DC24V/50HZ
外翅片散热面积 Fan power	1.3 m ²	注：特殊电压特殊尺寸可按要求定制 Special voltage size can be customized	



产品线图 PRODUCT LINE DIAGRAM

性能曲线 PERFORMANCE CURVE

产品线图 PRODUCT LINE DIAGRAM

性能曲线 PERFORMANCE CURVE

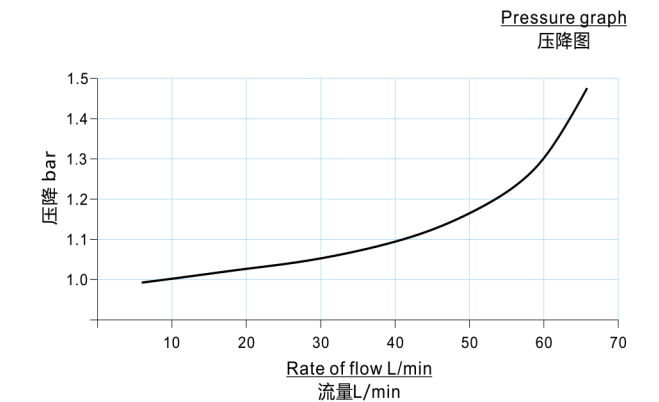
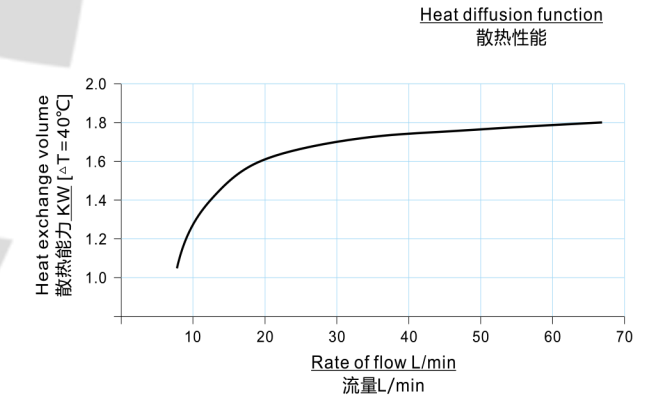
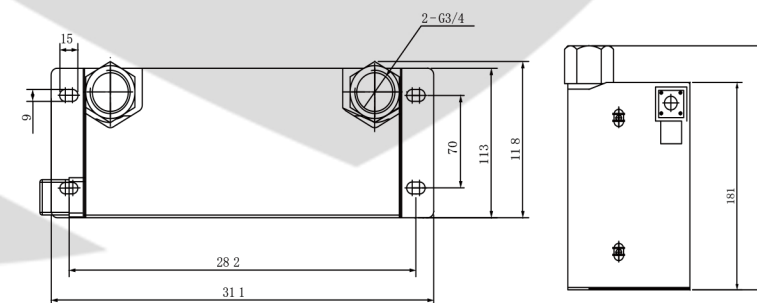
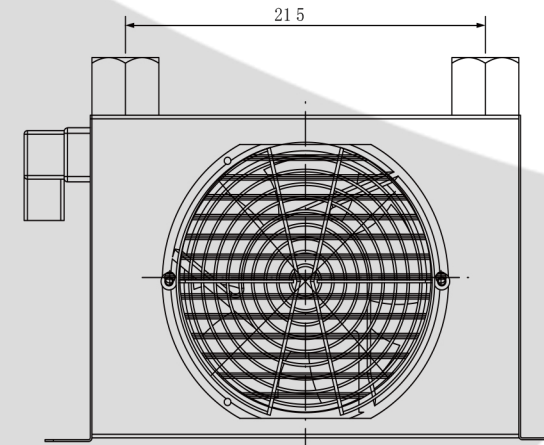
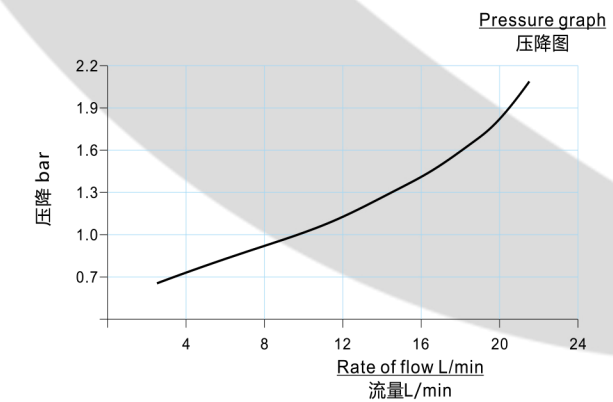
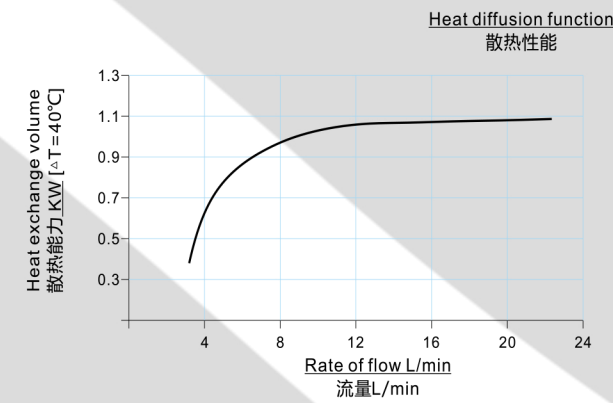
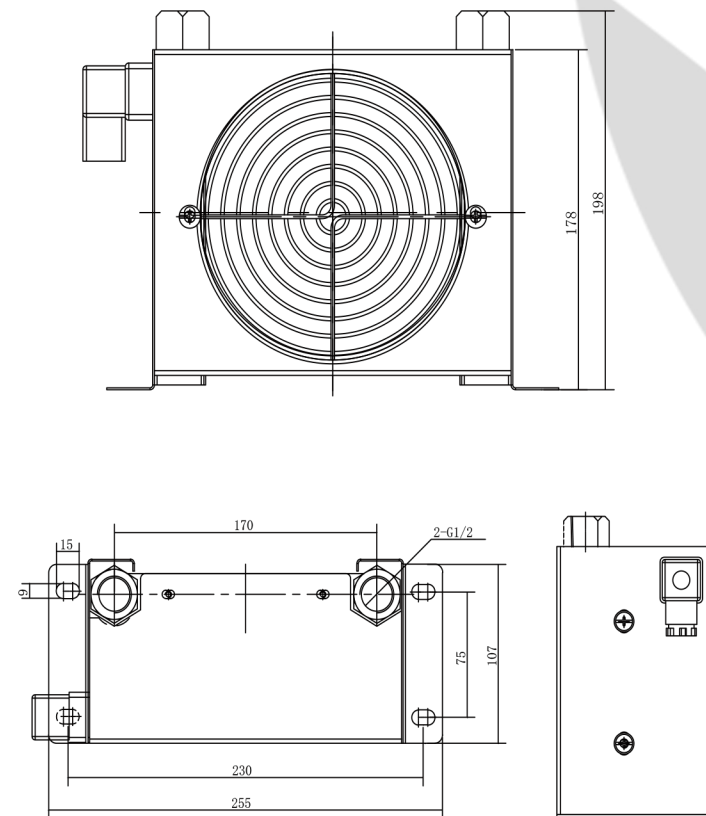

AJ 系列 X AJ SERIES

AJ0608TL



风冷却器 AIR COOLER

产品配置 PRODUCT CONFIGURATION			
形式 Form	AJ0608TL	冷却能力 Cooling capacity	2.4KW
流量 Flow	60L/min	重量 Weight	6KG
工作压力 Working pressure	≤ 2MPa	包装尺寸 Package size	44*14*21.5cm
风扇功率 Fan power	68W	风扇电压 Fan voltage	AC110V/AC220V-240V/AC380V/DC12V/DC24V/50HZ
外翅片散热面积 Fan power	1.8 m ²	注：特殊电压特殊尺寸可按要求定制 Special voltage size can be customized	



AJ 系列 X AJ SERIES

AJ1012T



风冷却器 AIR COOLER

产品配置 PRODUCT CONFIGURATION			
形式 Form	AJ1012T	冷却能力 Cooling capacity	5.8KW
流量 Flow	100L/min	重量 Weight	9.5KG
工作压力 Working pressure	≤ 2MPa	包装尺寸 Package size	45*22*37cm
风扇功率 Fan power	45/52W	风扇电压 Fan voltage	AC110V/AC220V-240V/AC380V/DC12V/DC24V/50HZ
外翅片散热面积 Fan power	3.2 m ²	注：特殊电压特殊尺寸可按要求定制 Special voltage size can be customized	



产品线图 PRODUCT LINE DIAGRAM

性能曲线 PERFORMANCE CURVE

产品线图 PRODUCT LINE DIAGRAM

性能曲线 PERFORMANCE CURVE

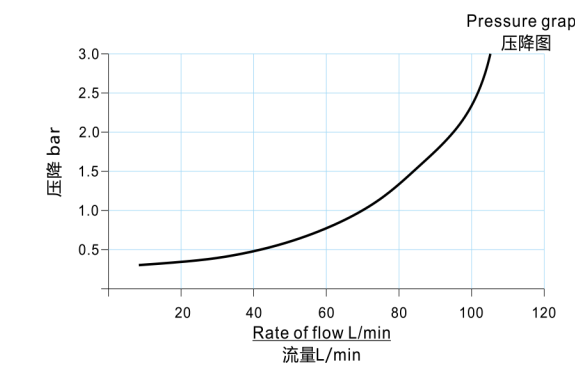
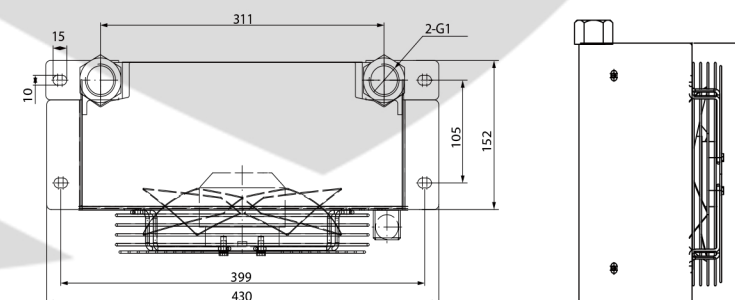
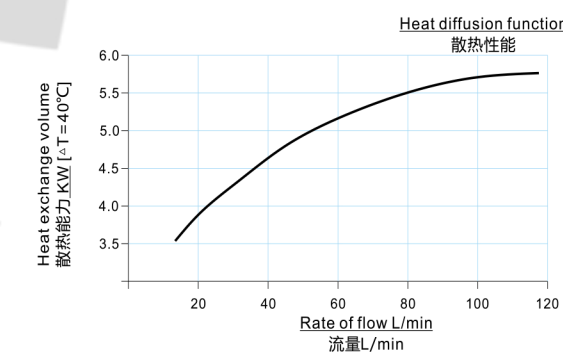
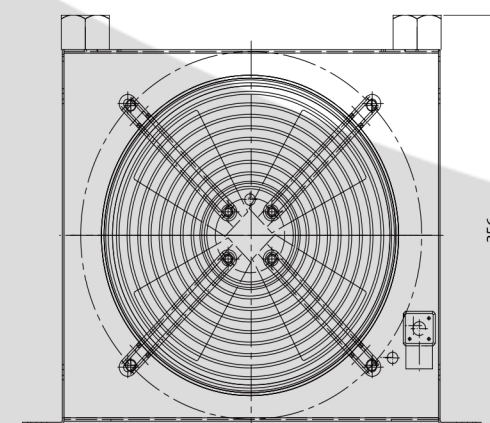
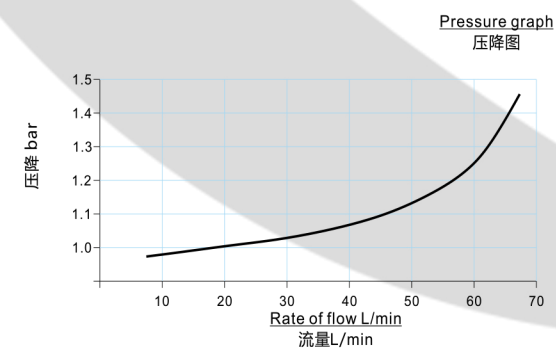
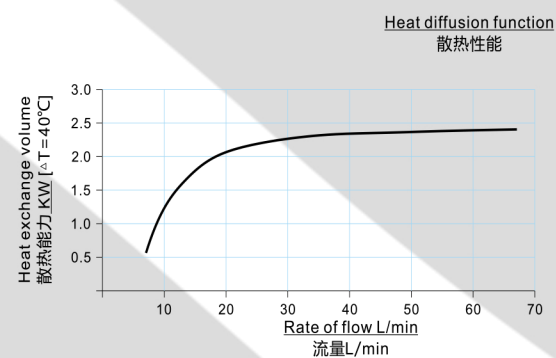
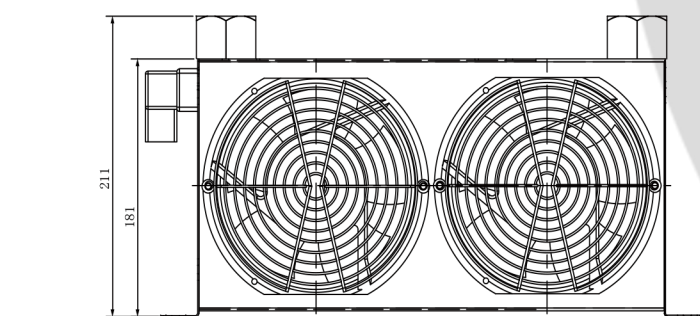

AH 系列 X AH SERIES

AH0607T-CA



风冷却器 AIR COOLER

产品配置 PRODUCT CONFIGURATION			
形式 Form	AH0607T-CA	冷却能力 Cooling capacity	1.05KW
流量 Flow	40L/min	重量 Weight	3.5KG
工作压力 Working pressure	≤ 2MPa	包装尺寸 Package size	28.5*14*22cm
风扇功率 Fan power	34W	风扇电压 Fan voltage	AC110V/AC220V-240V/AC380V/ DC12V/DC24V/50HZ
外翅片散热面积 Fan power	1 m ²	注：特殊电压特殊尺寸可按要求定制 Special voltage size can be customized	



AH 系列 X AH SERIES

AH0608T-CA



风冷却器 AIR COOLER

产品配置 PRODUCT CONFIGURATION			
形式 Form	AH0608T-CA	冷却能力 Cooling capacity	1.8KW
流量 Flow	60L/min	重量 Weight	4KG
工作压力 Working pressure	≤ 2MPa	包装尺寸 Package size	35.5*14*21.5cm
风扇功率 Fan power	34W	风扇电压 Fan voltage	AC110V/AC220V-240V/AC380V/ DC12V/DC24V/50HZ
外翅片散热面积 Fan power	1.3 m ²	注：特殊电压特殊尺寸可按要求定制 Special voltage size can be customized	



产品线图 PRODUCT LINE DIAGRAM

性能曲线 PERFORMANCE CURVE

产品线图 PRODUCT LINE DIAGRAM

性能曲线 PERFORMANCE CURVE

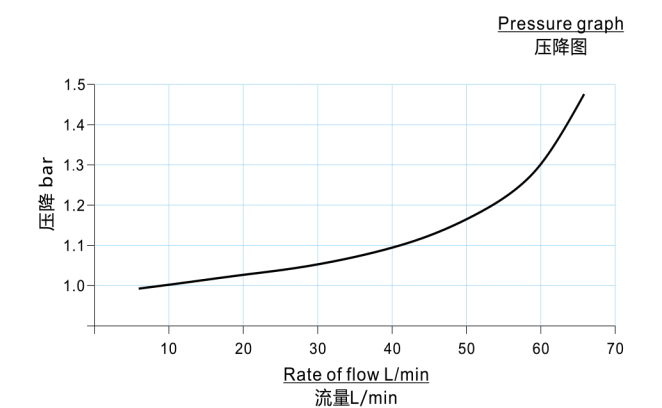
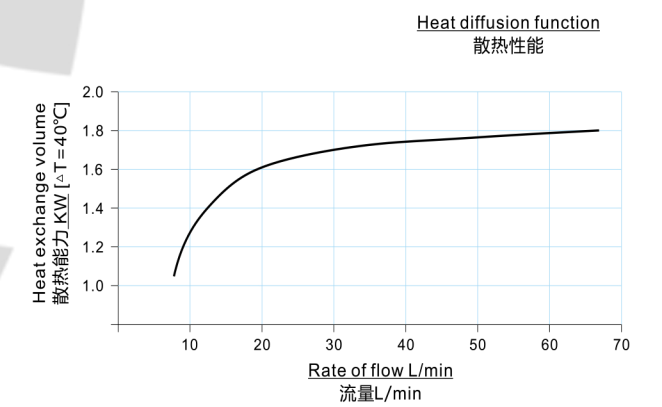
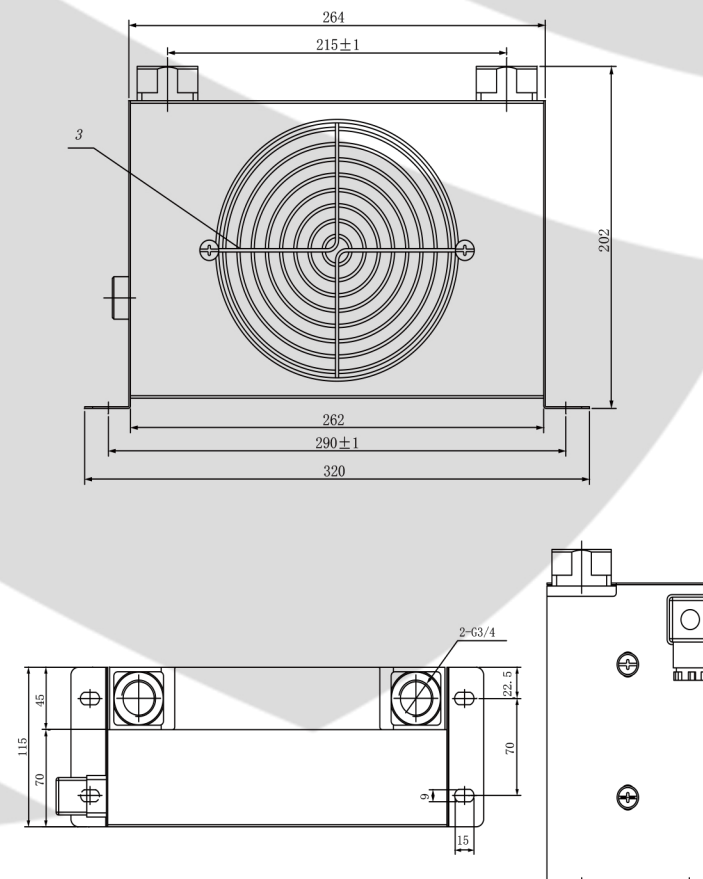
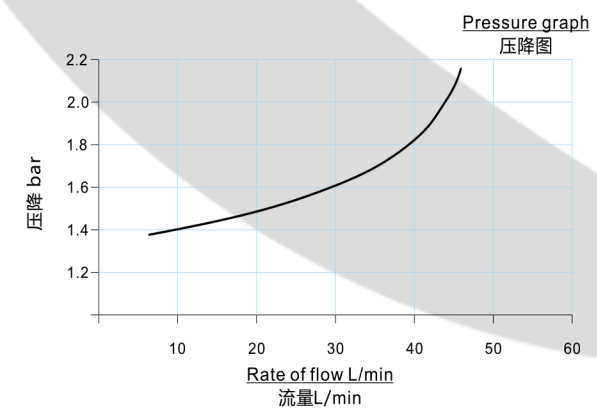
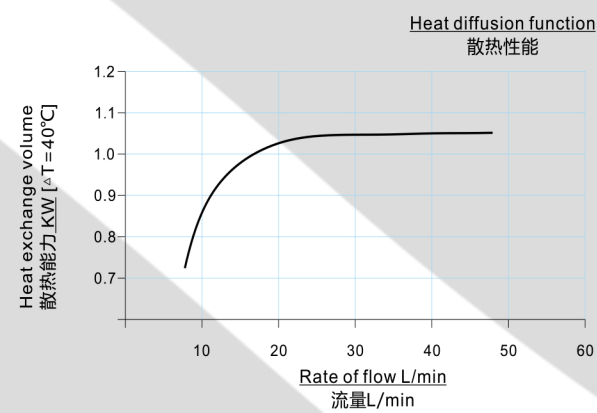
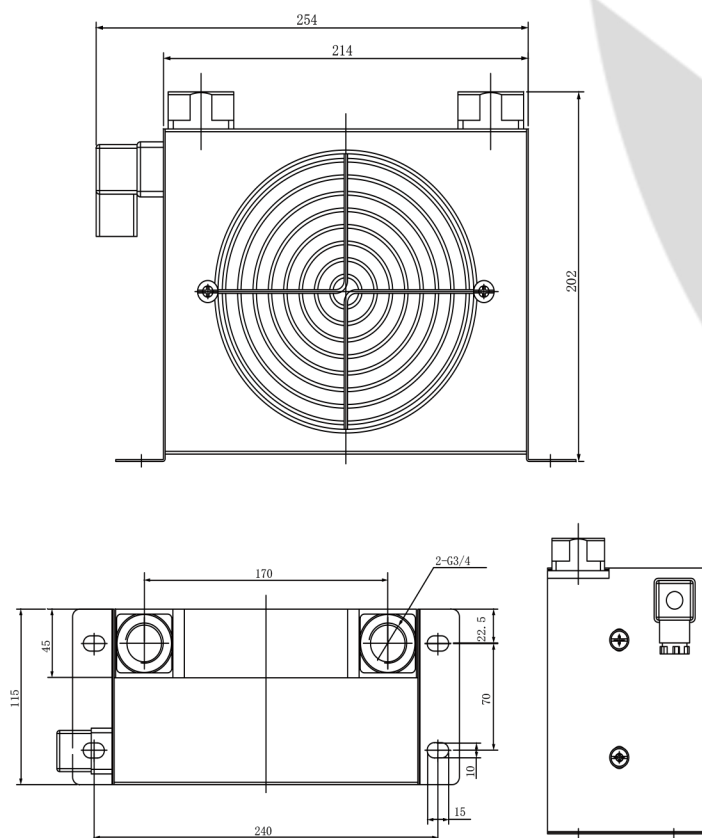

AH 系列 X AH SERIES

AH0608TL-CA



风冷却器 AIR COOLER

产品配置 PRODUCT CONFIGURATION			
形式 Form	AH0608TL-CA	冷却能力 Cooling capacity	2.4KW
流量 Flow	60L/min	重量 Weight	6KG
工作压力 Working pressure	≤ 2MPa	包装尺寸 Package size	44*14*21.5cm
风扇功率 Fan power	68W	风扇电压 Fan voltage	AC110V/AC220V-240V/AC380V/ DC12V/DC24V/50HZ
外翅片散热面积 Fan power	1.8 m ²	注：特殊电压特殊尺寸可按要求定制 Special voltage size can be customized	



AH 系列 X AH SERIES

AH1012T



风冷却器 AIR COOLER

产品配置 PRODUCT CONFIGURATION			
形式 Form	AH1012T	冷却能力 Cooling capacity	5.8KW
流量 Flow	100L/min	重量 Weight	9.5KG
工作压力 Working pressure	≤ 2MPa	包装尺寸 Package size	45*22*37cm
风扇功率 Fan power	45/52W	风扇电压 Fan voltage	AC110V/AC220V-240V/AC380V/ DC12V/DC24V/50HZ
外翅片散热面积 Fan power	3.2 m ²	注：特殊电压特殊尺寸可按要求定制 Special voltage size can be customized	



产品线图 PRODUCT LINE DIAGRAM

性能曲线 PERFORMANCE CURVE

产品线图 PRODUCT LINE DIAGRAM

性能曲线 PERFORMANCE CURVE

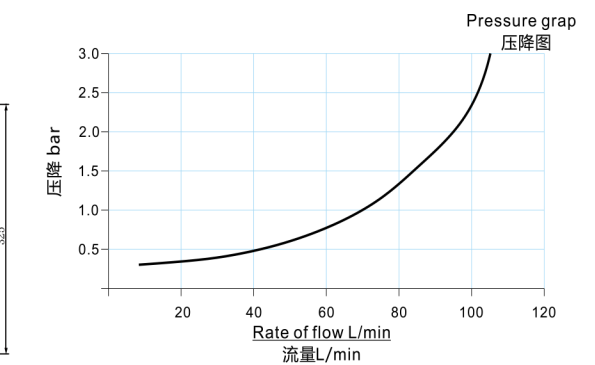
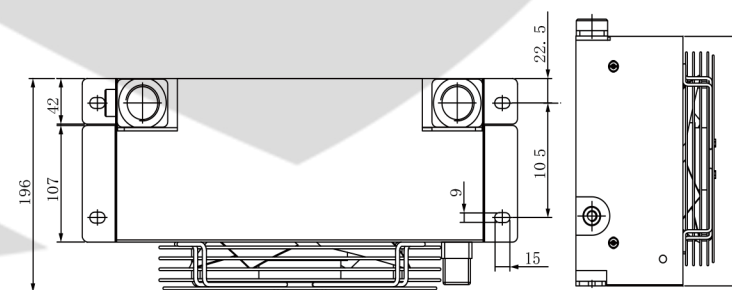
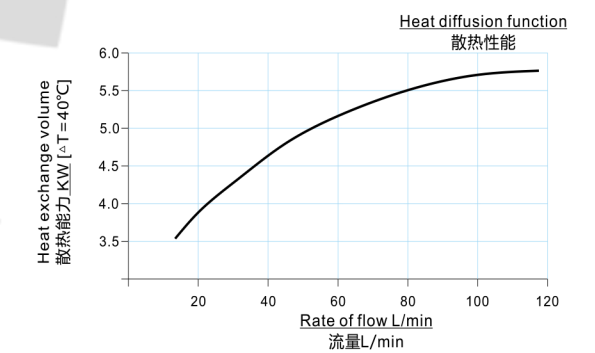
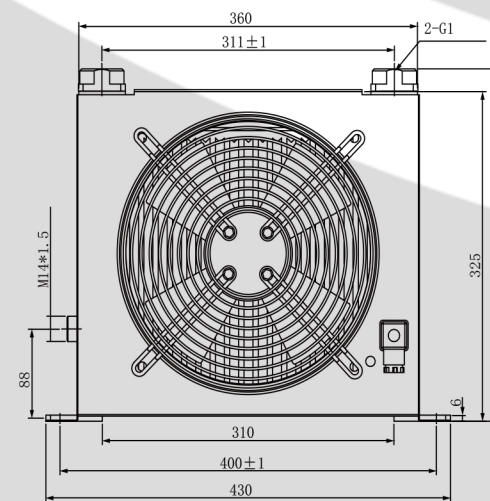
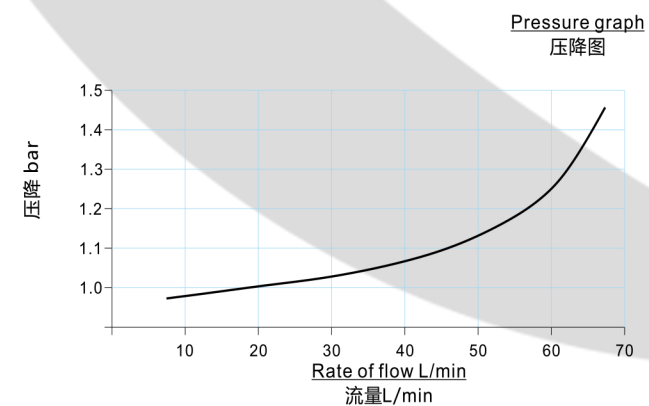
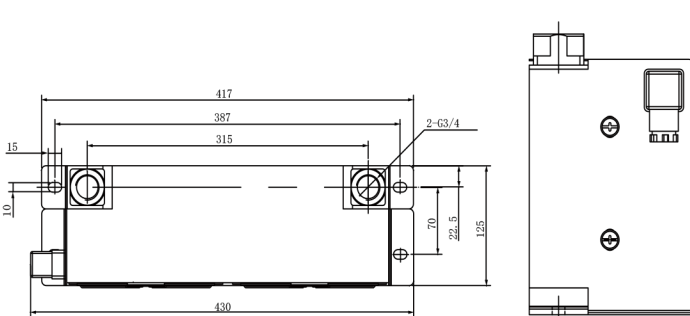
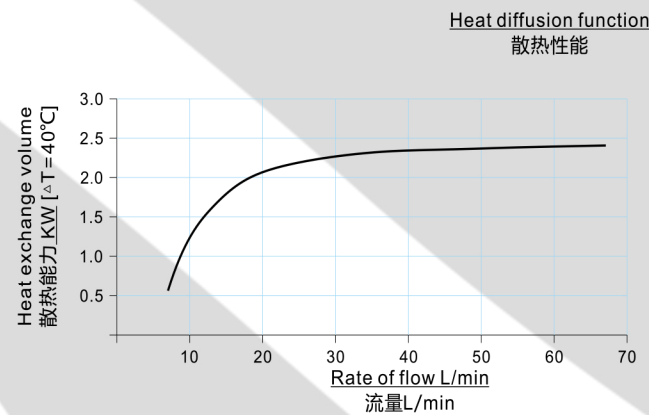
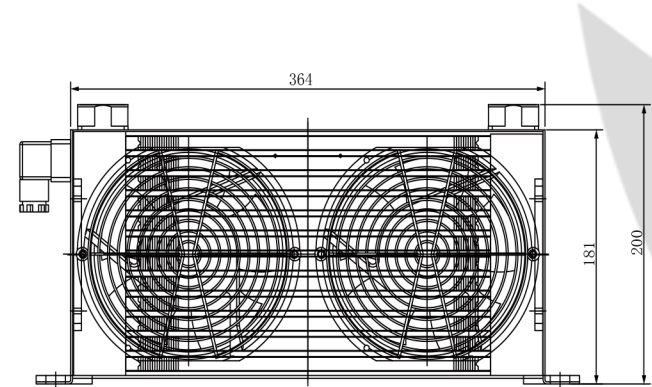

AH系列 X AH SERIES

AH1012T1



风冷却器 AIR COOLER

产品配置 PRODUCT CONFIGURATION			
形式 Form	AH1012T1	冷却能力 Cooling capacity	5.8KW
流量 Flow	50L/min	重量 Weight	9.5KG
工作压力 Working pressure	≤ 2MPa	包装尺寸 Package size	45*22*35cm
风扇功率 Fan power	45/52W	风扇电压 Fan voltage	AC110V/AC220V-240V/AC380V/DC12V/DC24V/50HZ
外翅片散热面积 Fan power	3.2 m ²	注：特殊电压特殊尺寸可按要求定制 Special voltage size can be customized	



AH系列 X AH SERIES

AH1417T-CA



风冷却器 AIR COOLER

产品配置 PRODUCT CONFIGURATION			
形式 Form	AH1417T-CA	冷却能力 Cooling capacity	8KW
流量 Flow	150L/min	重量 Weight	20.5KG
工作压力 Working pressure	≤ 2MPa	包装尺寸 Package size	58.5*35*41cm
风扇功率 Fan power	142W/135W	风扇电压 Fan voltage	AC110V/AC220V-240V/AC380V/DC12V/DC24V/50HZ
外翅片散热面积 Fan power	6.2 m ²	注：特殊电压特殊尺寸可按要求定制 Special voltage size can be customized	



产品线图 PRODUCT LINE DIAGRAM

性能曲线 PERFORMANCE CURVE

产品线图 PRODUCT LINE DIAGRAM

性能曲线 PERFORMANCE CURVE

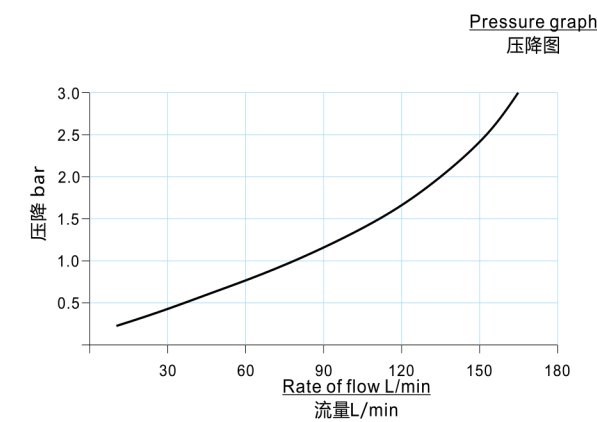
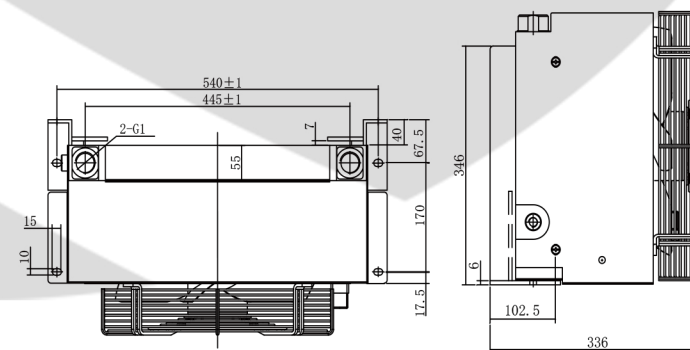
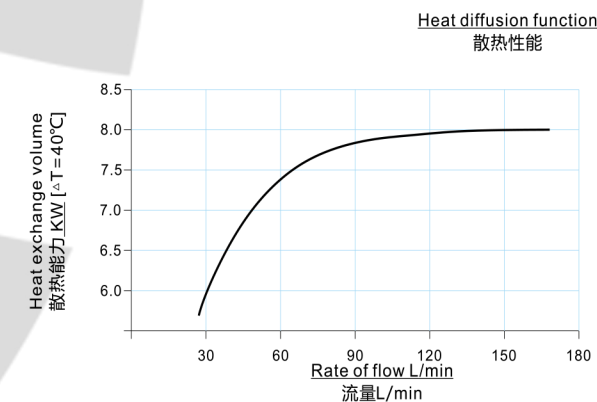
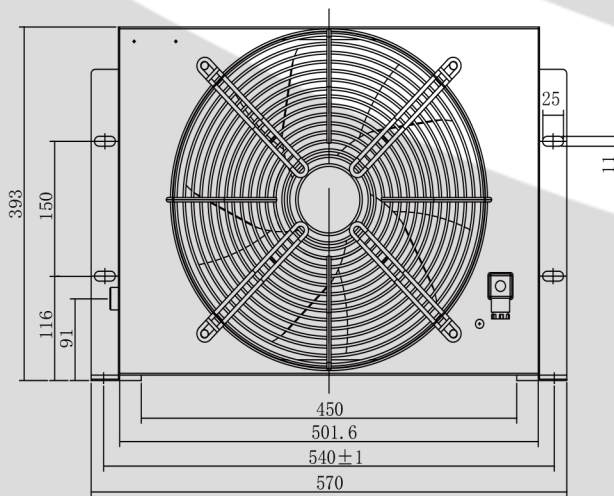
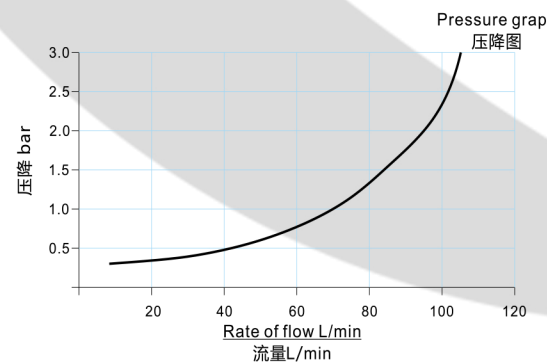
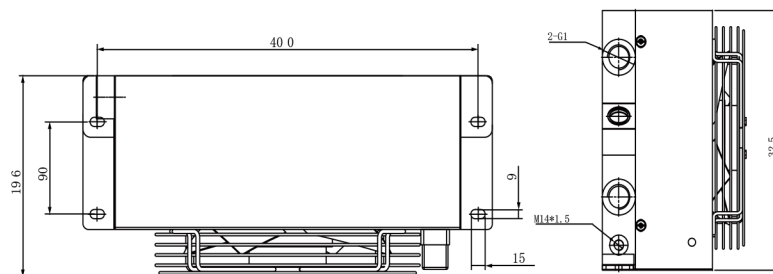
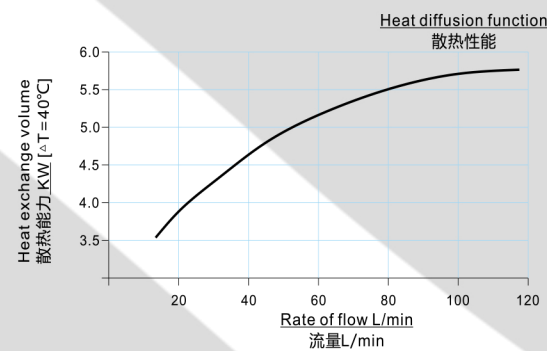
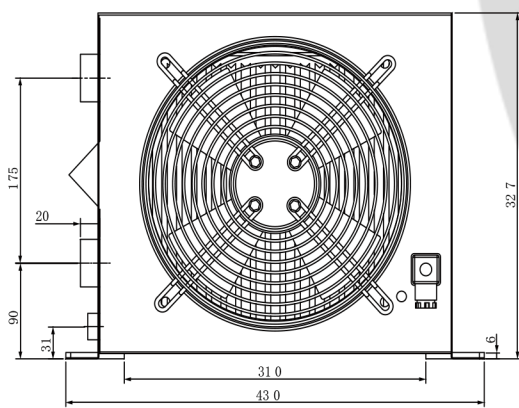

AH 系列 X AH SERIES

AH1470T-AC



风冷却器 AIR COOLER



产品配置 PRODUCT CONFIGURATION			
形式 Form	AH1470T-AC	冷却能力 Cooling capacity	8.8KW
流量 Flow	200L/min	重量 Weight	21.5KG
工作压力 Working pressure	≤ 2MPa	包装尺寸 Package size	59*36.5*41cm
风扇功率 Fan power	142W/135W	风扇电压 Fan voltage	AC110V/AC220V-240V/AC380V/DC12V/DC24V/50HZ
外翅片散热面积 Fan power	8.3 m ²	注：特殊电压特殊尺寸可按要求定制 Special voltage size can be customized	

AH 系列 X AH SERIES

AH1490T-CA



风冷却器 AIR COOLER



产品配置 PRODUCT CONFIGURATION			
形式 Form	AH1490T-CA	冷却能力 Cooling capacity	11.5KW
流量 Flow	250L/min	重量 Weight	23KG
工作压力 Working pressure	≤ 2MPa	包装尺寸 Package size	59*38.5*41cm
风扇功率 Fan power	142W/135W	风扇电压 Fan voltage	AC110V/AC220V-240V/AC380V/DC12V/DC24V/50HZ
外翅片散热面积 Fan power	10.5 m ²	注：特殊电压特殊尺寸可按要求定制 Special voltage size can be customized	

产品线图 PRODUCT LINE DIAGRAM

性能曲线 PERFORMANCE CURVE

产品线图 PRODUCT LINE DIAGRAM

性能曲线 PERFORMANCE CURVE

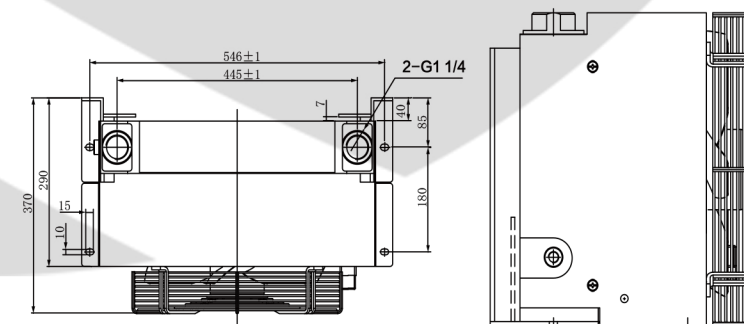
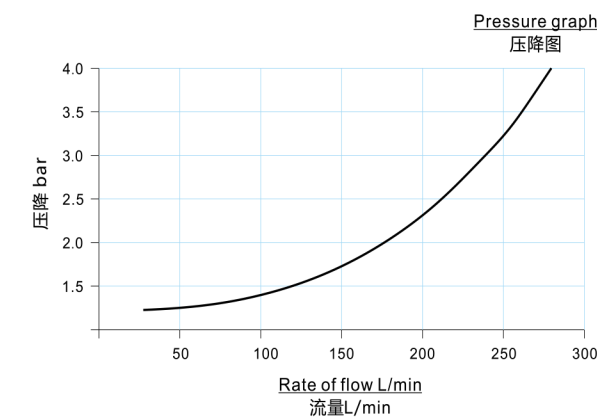
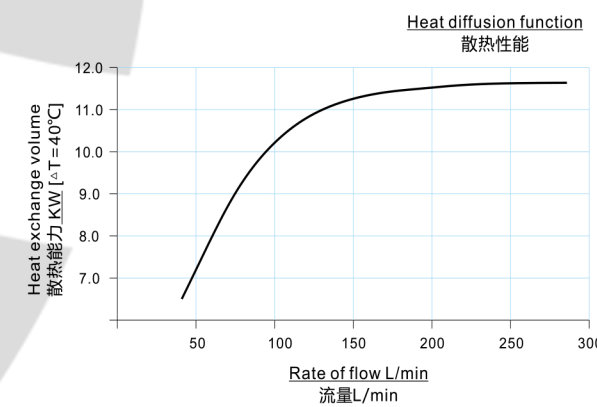
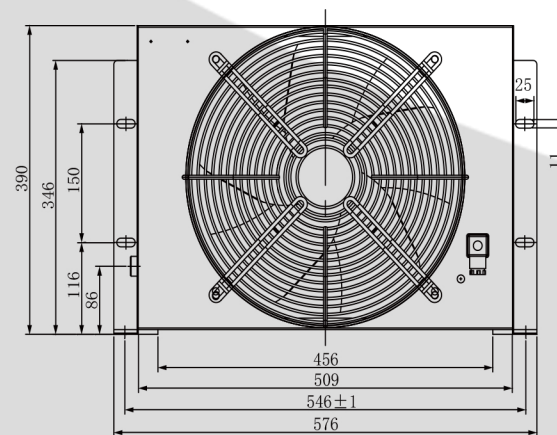
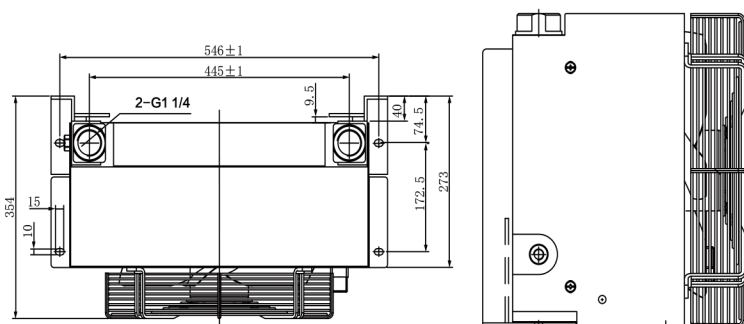
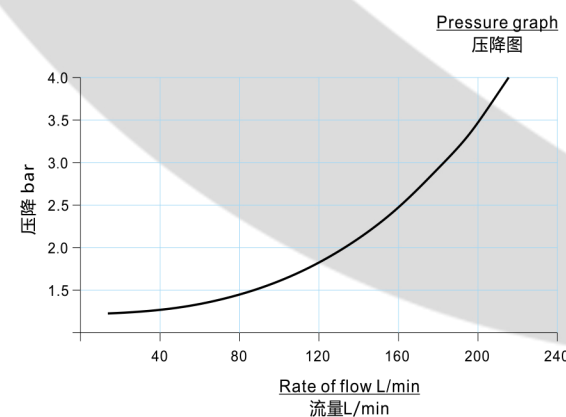
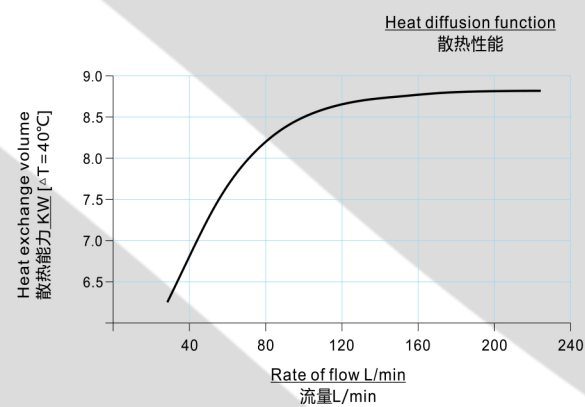
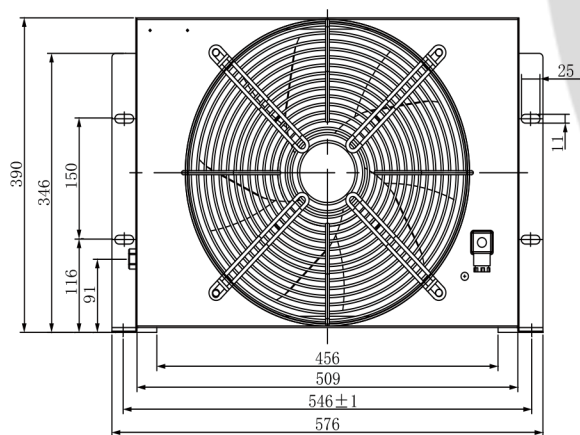

AH 系列 X AH SERIES

AH1680T-CA



风冷却器 AIR COOLER

产品配置 PRODUCT CONFIGURATION			
形式 Form	AH1680T-CA	冷却能力 Cooling capacity	19KW
流量 Flow	300L/min	重量 Weight	51KG
工作压力 Working pressure	≤ 2MPa	包装尺寸 Package size	82*42*66cm
风扇功率 Fan power	423W/448W	风扇电压 Fan voltage	AC220V-240V/AC380V/50HZ
外翅片散热面积 Fan power	14 m ²	注：特殊电压特殊尺寸可按要求定制 Special voltage size can be customized	



AH 系列 X AH SERIES

AH2431T-CA



风冷却器 AIR COOLER

产品配置 PRODUCT CONFIGURATION			
形式 Form	AH2431T-CA	冷却能力 Cooling capacity	34KW
流量 Flow	450L/min	重量 Weight	73KG
工作压力 Working pressure	≤ 2MPa	包装尺寸 Package size	92*46*84cm
风扇功率 Fan power	836W	风扇电压 Fan voltage	AC380V/50HZ
外翅片散热面积 Fan power	33.2 m ²	注：特殊电压特殊尺寸可按要求定制 Special voltage size can be customized	



产品线图 PRODUCT LINE DIAGRAM

性能曲线 PERFORMANCE CURVE

产品线图 PRODUCT LINE DIAGRAM

性能曲线 PERFORMANCE CURVE

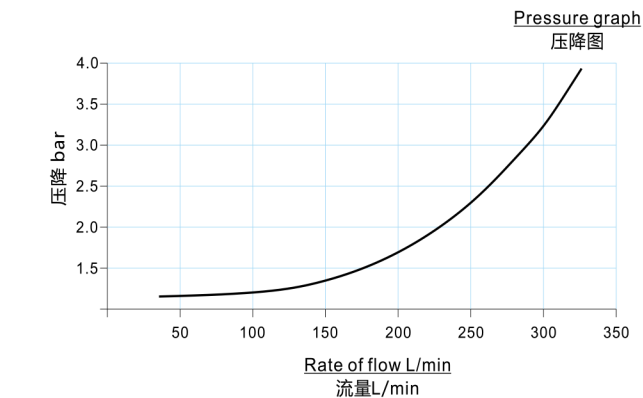
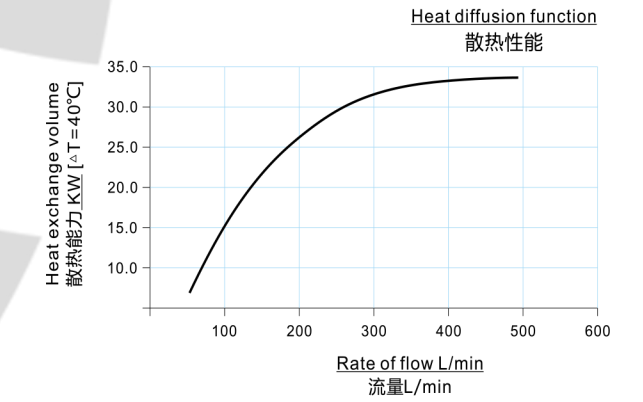
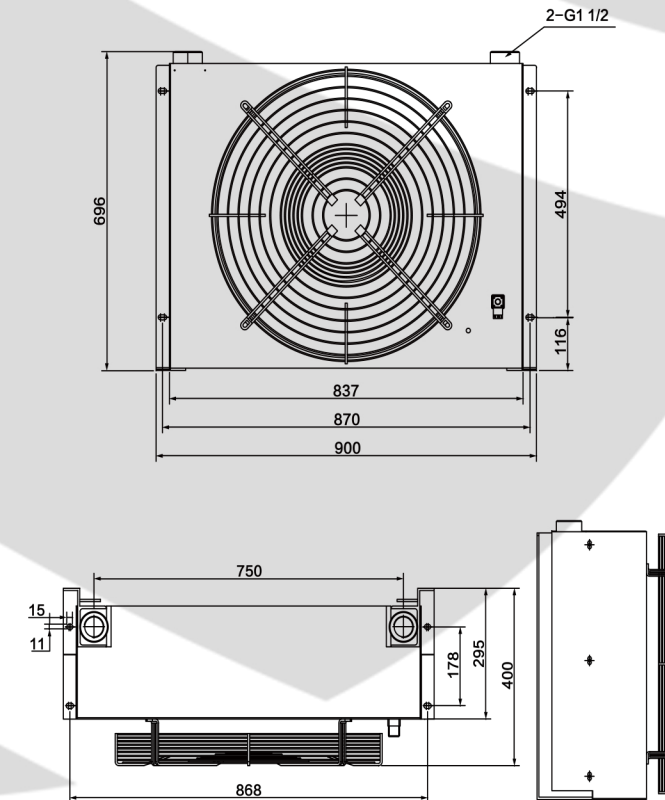
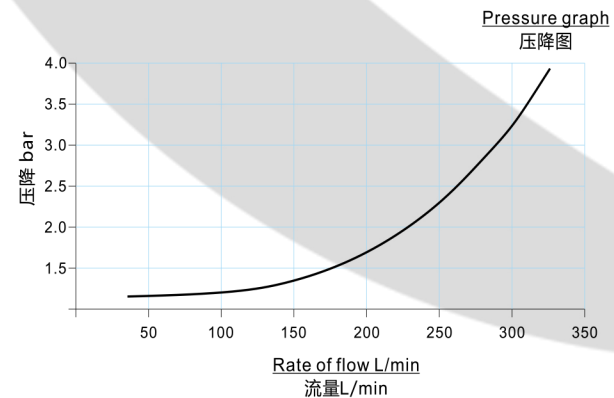
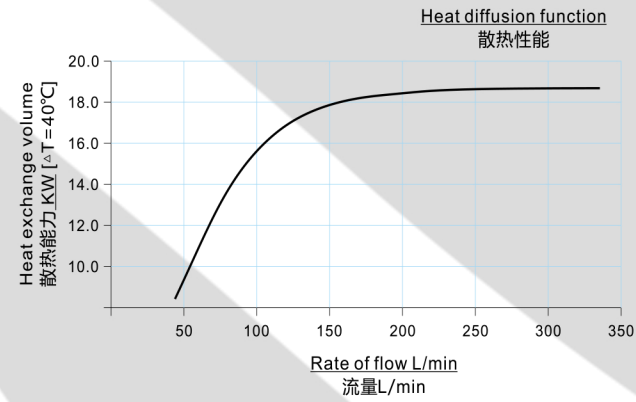
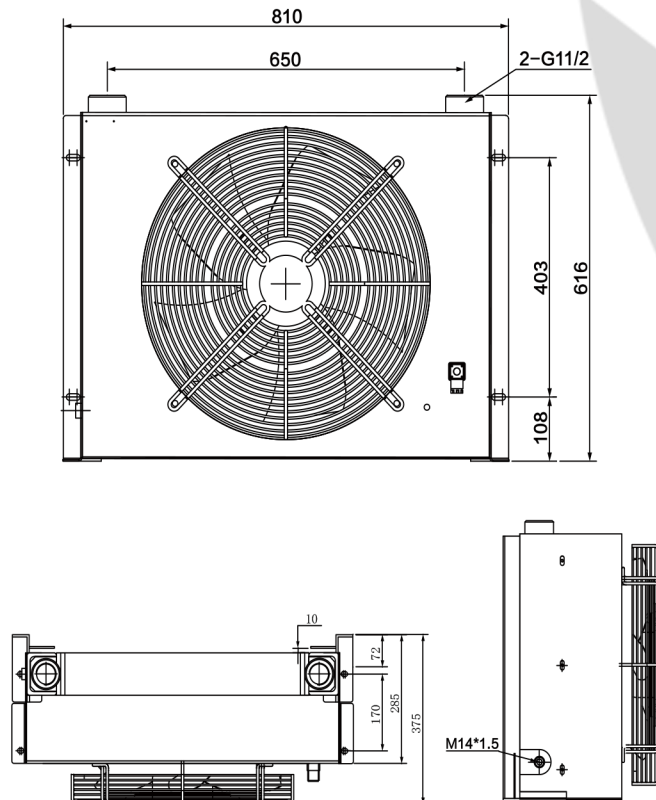

产品应用 X ELECTRONIC EQUIPMENT THERMAL MANAGEMENT SYSTEM

电子设备热管理系统



计算机液冷系统 X Computer liquid cooling system



冷凝器系统 X Condenser system

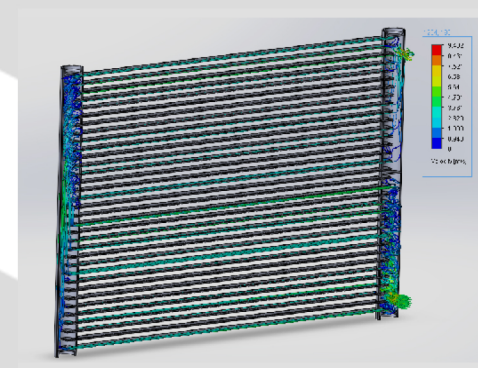

计算机液冷系统 X Computer liquid cooling system



服务器液冷系统 X Computer liquid cooling system



产品应用 X POWER EQUIPMENT THERMAL MANAGEMENT SYSTEM

电力设备热管理系统



发电设备热管理系统 X Power generation equipment



配电设备热管理系统 X Power distribution equipment heat



发电机热管理系统 X Generator thermal management system



油冷机系统 X Oil cooler system



热交换器系统 X hot box

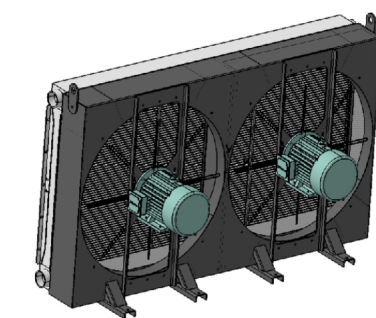

产品应用 X NEW ENERGY THERMAL MANAGEMENT SYSTEM

新能源热管理系统



车辆热管理系统 X Vehicle thermal management system

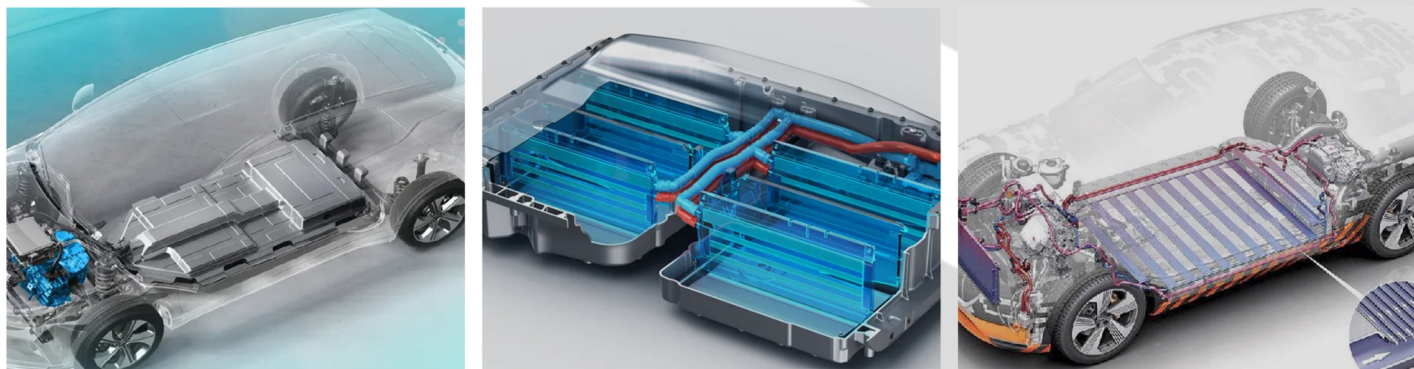

充电桩热管理系统 X Thermal management system of charging pile



储能装置热管理系统 X Thermal management of energy storage device



特种车热管理系统 X Thermal management of special vehicles



产品应用 X SPECIAL EQUIPMENT THERMAL MANAGEMENT SYSTEM

特种设备热管理系统



冷水机系统 X Chiller system



矿山设备热管理系统 X Equipment thermal management system



激光设备热管理系统 X Thermal management system of laser equipment



数控热管理系统 X Equipment thermal management system



液压设备热管理系统 X Thermal management of hydraulic equipment

